

UniFi UISP Branding

Q UA-G3

Switching WiFi Camera Security Door Access CloudKeys & Gateways Power Tech Inte

Readers > G3 Reader

Datasheet

In The Box

Marketing Images

Installation Guide

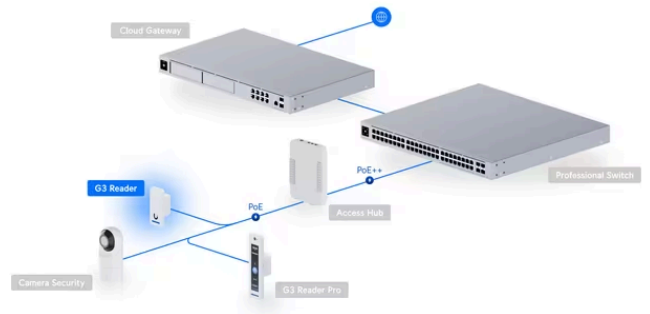
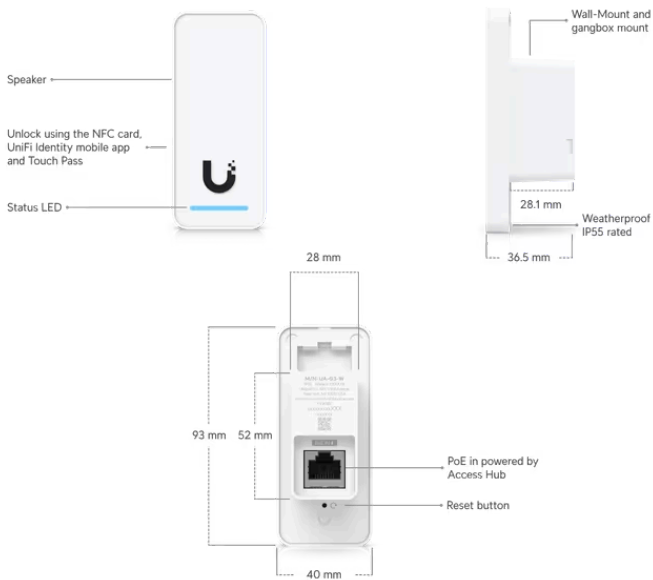

## Mechanical

**Dimensions** 93 x 40 x 36.5 mm (3.7 x 1.6 x 1.4")

**Weight** 82 g (2.9 oz)

**Enclosure material** Polycarbonate, glass

**Mounting material** Aluminum alloy

**Mounting** In wall, gang box

**Weatherproofing** IP55

## Hardware

<b>Networking interface</b>	(1) 10/100 MbE RJ45 port
<b>Connectivity</b>	BLE 4.1 NFC
<b>Power method</b>	PoE UL 294 Power-limited Class 2 PSU UL 60950-1/62368-1 LPS/PS2 PSU
<b>Supported voltage range</b>	48V DC
<b>Max. power consumption</b>	5W
<b>ESD/EMP protection</b>	Air: ±15kV, contact: ±8kV
<b>Sensors</b>	Proximity sensor
<b>Speaker</b>	(1) 8 ohm, 0.7W
<b>LEDs</b>	(1) Status light (Learn more)
<b>Button</b>	(1) Factory-reset
<b>NFC frequency</b>	13.56 MHz
<b>NFC read range</b>	< 30 mm
<b>NFC technology</b>	ISO/IEC 14443A / 14443B / 15693 / 18092 (Ecma 340) MIFARE Classic / MIFARE DESFIRE Sony FeliCa™ (ID only) NFC Forum tags T1T, T2T, T3T, T4T and T5T ECP 2.0
<b>Operating environment</b>	Outdoor use
<b>Ambient operating temperature</b>	-30 to 45° C (-22 to 113° F)
<b>Ambient operating humidity</b>	5 to 90% noncondensing
<b>Software information</b>	The software version of a product can be checked at <a href="https://unifi.ui.com">https://unifi.ui.com</a>
<b>UL 294 level</b>	Destructive attack: Level I Line security: Level I Endurance: Level I Standby power: Level I
<b>UL 294 statement</b>	Compliance with IEEE 802.3 specifications was not verified as part of UL 294. The equipment is intended to comply with the section of the National Electrical Code, ANSI/NFPA 70, Article 725.121, Power Sources for Class 2 and Class 3 Circuits.
<b>PoE cabling requirements</b>	Cable 5e cabling is the minimum performance category recommended. The performance category utilized should match the transmission speed required at the installation site.

The minimal conductor gauge permitted to connect between the PSE or power injector and the PD shall be 26 AWG (0.13 mm<sup>2</sup>) for patch cords; 24 AWG (0.21 mm<sup>2</sup>) for horizontal or riser cable.

<b>CAN/ULC-60839-11-1 Grade</b>	Grade assignment: I
<b>Certifications</b>	CE, FCC, IC, UL 294, CAN/ULC-60839-11-1
<b>Document number, and issue date and/or revision level</b>	UA-G3, V01

---

## Software

<b>Management application</b>	UniFi Access: Version 3.0.15 and later
-------------------------------	--

### Stay in Touch

[Terms of Service](#) | [Privacy Policy](#) | [Legal](#) | [Cookies Settings](#)

© 2025 Ubiquiti, Inc. All rights reserved.