

Switching WiFi Camera Security Door Access Cloud Keys & Gateways Power Tech New I

Door Access > [G2 Starter Kit Pro](#)

Datasheet

Marketing Images

Installation Guide

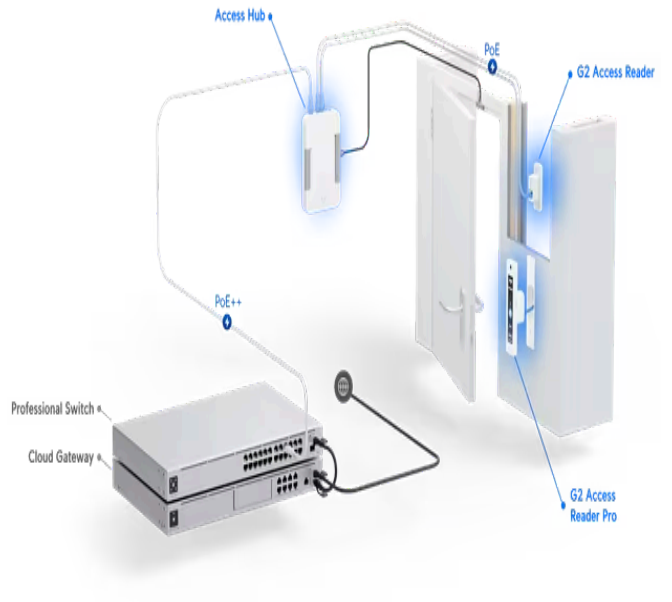
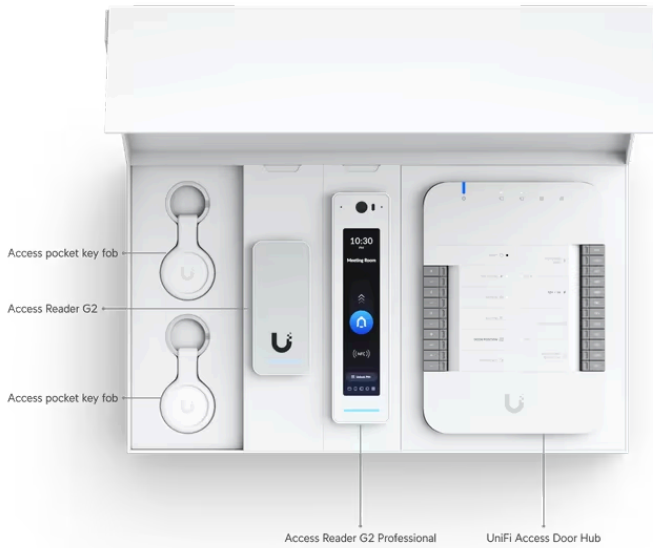

UA-Hub-Door Mechanical

Dimensions 174.9 x 126 x 32.9 mm (6.9 x 5 x 1.3")

Weight 363 g (12.8 oz)

Enclosure material Polycarbonate

Mounting material Polycarbonate

Hardware

Networking interface	(5) 10/100/1000 Base-T
Power method	PoE++ UL 294 Power-limited Class 2 PSU UL 60950/62368 LPS/PS2 PSU
Max. power consumption	Without PoE output: 30W With PoE output: 50W
PoE input	50V DC, 1A
PoE output	PoE passthrough, (4) PoE, 50V DC, total 20W
Button	(1) Factory-reset
LEDs	System: white/blue Output relays: white
Digital input	Request to exit/request to enter/remote release/door position sensor
Dry output relay	Lock: 30V DC, 1A Aux: 30V DC, 1A
Powered output relay	Lock: 12V DC, 1A Aux: 12V DC, 0.33A 12V DC, 0.33A
Operating environment	Indoor use only
Ambient operating temperature	0 to 40° C (32 to 104° F)
Ambient operating humidity	5 to 95% noncondensing
UL 294 level	Destructive attack: Level I Line security: Level I Endurance: Level I Standby power: Level I
UL 294 statement	Compliance with IEEE 802.3 (at or af) specifications was not verified as per UL 294. The equipment is intended to comply with the section of the National Electrical Code (NEC) 725.121, Power Sources for Class 2 and Class 3 Circuits.
CAN/ULC-60839-11-1 Grade	Grade assignment: 1
Certifications	CE, FCC, IC, UL 294, CAN/ULC-60839-11-1
Document number, and issue date and/or revision level	UA-Hub-Door002, V01

Wiring Information

Wiring gauge requirements (AWG)	Total length to device	Output load current at 12V DC
---------------------------------	------------------------	-------------------------------

100mA

6.1 m (20 ft) 22

15.2 m (50 ft) 22

30.5 m (100 ft) 22

UACC-Cable-DoorLockRelay (18 AWG) is recommended.

PoE cabling requirements

The minimal conductor gauge permitted to connect between the PSE or p
(0.21 mm²) for horizontal or riser cable.

LEDs**PoE in**

Steady blue: Adopted/device is ready
Steady white: Pending adoption
Blinking white/blue: Upgrading firmware

PoE out

Off: Not connected or no data link
Steady blue: Connected and data link on

UA-G2-Pro**Mechanical****Dimensions**

160 x 40.4 x 40.55 mm (6.3 x 1.59 x 1.6")

Weight

136 g (4.8 oz)

Enclosure material

Polycarbonate, glass

Mount material

Aluminum alloy

Mounting

Wall, gang box

Weatherproofing

IP55

Hardware**Networking interface**

(1) GbE RJ45 port

Connectivity

BLE 4.2
NFC

Power method	PoE UL 294 Power-limited Class 2 PSU UL 60950-1/62368-1 LPS/PS2 PSU
Supported voltage range	48V DC
Max. power consumption	6W
ESD/EMP protection	Air: ±15kV, contact: ±8kV
Sensor	Proximity sensor
Camera	4000 x 3000, 12 MP, 30 FPS
View angle	H: 96.67°, V: 123.15°, D: 153.11°
Microphone	Yes
Speaker	(1) 4 ohm, 1.5W
LEDs	R/G/B/W Flash
Button	(1) Factory-reset
NFC frequency	13.56 MHz
NFC read range	< 30 mm
NFC standards	ISO 14443A, 14443B, 15693
NFC technology	NFC Tag 1,2,3,4,5 MIFARE Classic MIFAREPlus MIFARE Ultralight MIFARE DESFire
Operating environment	Outdoor use
Ambient operating temperature	Device: -30 to 45° C (-22 to 113° F) Display:* -10 to 45° C (14 to 113° F) *The display will turn off when the ambient temperature is above/below the display oper functional. (Effective after firmware v1.3.28)
Ambient operating humidity	5 to 90% noncondensing
Software information	The software version of a product can be checked at https://unifi.ui.com
UL 294 level	Destructive attack: Level I Line security: Level I Endurance: Level I Standby power: Level I
UL 294 statement	Compliance with IEEE 802.3 specifications was not verified as part of UL The equipment is intended to comply with the section of the National Ele

725.121, Power Sources for Class 2 and Class 3 Circuits.

PoE cabling requirements

Cable 5e cabling is the minimum performance category recommended. The cable must match the transmission speed required at the installation site.

The minimal conductor gauge permitted to connect between the PSE or powered device (PD) is 24 AWG (0.13 mm²) for patch cords; 24 AWG (0.21 mm²) for horizontal or riser cables.

CAN/ULC-60839-11-1 Grade

Grade assignment: I

Certifications

CE, FCC, IC, UL 294, CAN/ULC-60839-11-1

Document number, and issue date and/or revision level

UA-G2-Pro/UA-G2-Pro-Black, V02

LED**System**

Steady blue: Adopted/device is ready
 Steady white: Pending adoption
 Blinking white/blue: Upgrading firmware
 Strobing red: Emergency lockdown

UA-G2**Mechanical****Dimensions**

93 x 40 x 36.5 mm (3.7 x 1.6 x 1.4")

Weight

82 g (2.9 oz)

Enclosure material

Polycarbonate, glass

Mounting

In wall, gang box

Weatherproofing

IP55

Hardware**Networking interface**

(1) 10/100 MbE RJ45 port

Connectivity

BLE 4.1

Power method

PoE
 UL 294 Power-limited Class 2 PSU
 UL 60950-1/62368-1 LPS/PS2 PSU

Supported voltage range

48V DC

Max. power consumption

5W

ESD/EMP protection	Air: ±15kV, contact: ±8kV
Sensors	Proximity sensor
Speaker	(1) 8 ohm, 0.7W
LEDs	R/G/B/W
Button	(1) Factory-reset
NFC frequency	13.56 MHz
NFC read range	< 30 mm
NFC standards	ISO 14443A, 14443B, 15693
NFC technology	NFC Tag 1,2,3,4,5 MIFARE Classic MIFAREPlus MIFARE Ultralight MIFARE DESFire
Operating environment	Outdoor use
Ambient operating temperature	-30 to 45° C (-22 to 113° F)
Ambient operating humidity	5 to 90% noncondensing
Software information	The software version of a product can be checked at https://unifi.ui.com
UL 294 level	Destructive attack: Level I Line security: Level I Endurance: Level I Standby power: Level I
UL 294 statement	Compliance with IEEE 802.3 specifications was not verified as part of UL. The equipment is intended to comply with the section of the National Electrical Code 725.121, Power Sources for Class 2 and Class 3 Circuits.
PoE cabling requirements	Cable 5e cabling is the minimum performance category recommended. To match the transmission speed required at the installation site. The minimal conductor gauge permitted to connect between the PSE or powered device (PD) is 24 AWG (0.21 mm ²) for horizontal or riser cables; 20 AWG (0.52 mm ²) for patch cords.
CAN/ULC-60839-11-1 Grade	Grade assignment: I
Certifications	CE, FCC, IC, UL 294, CAN/ULC-60839-11-1
Document number, and issue date and/or revision level	UA-G2/UA-G2-Black, V02

LED

System

Steady blue: Adopted/device is ready
Steady white: Pending adoption
Blinking white/blue: Upgrading firmware
Strobing red: Emergency lockdown

**UA-Pocket
Mechanical**

Dimensions	84 x 39 x 7.4 mm (3.3 x 1.5 x 0.29")
Weight	16 g (0.56 oz)
Enclosure material	Polycarbonate, stainless steel
Weatherproofing	IP54

Hardware

NFC frequency	13.56 MHz
NFC technology	ISO/IEC 14443 Type A MIFARE DESFire EV3 4K UniFi Access Proprietary Security Protocol
Ambient operating temperature	-10 to 45° C (14 to 113° F)
Ambient operating humidity	10 to 90% noncondensing
Certification	CE

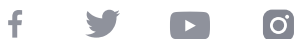
Stay in Touch

[Terms and Conditions](#) | [Terms of Service](#) | [Privacy Policy](#) | [Return Policy](#) | [Cookies Settings](#)

© 2024 Ubiquiti, Inc. All rights reserved.