

Switching WiFi Camera Security Door Access Cloud Keys & Gateways Power Tech New I

Door Access > [G2 Starter Kit](#)

Datasheet

Marketing Images

Installation Guide

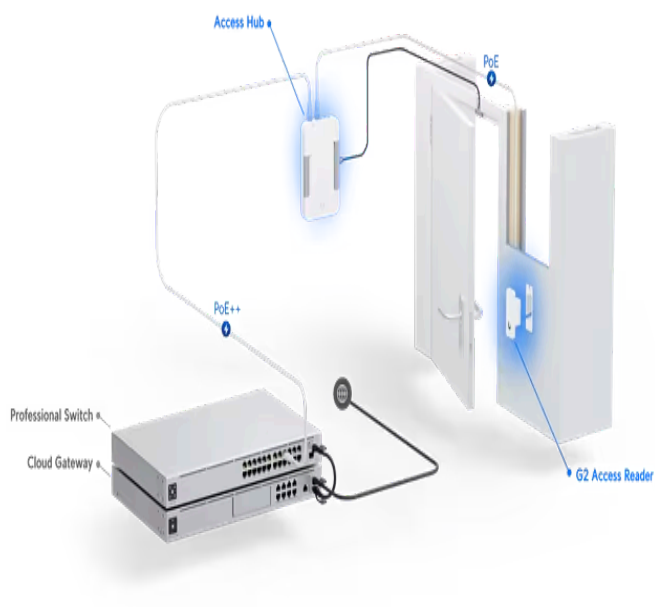
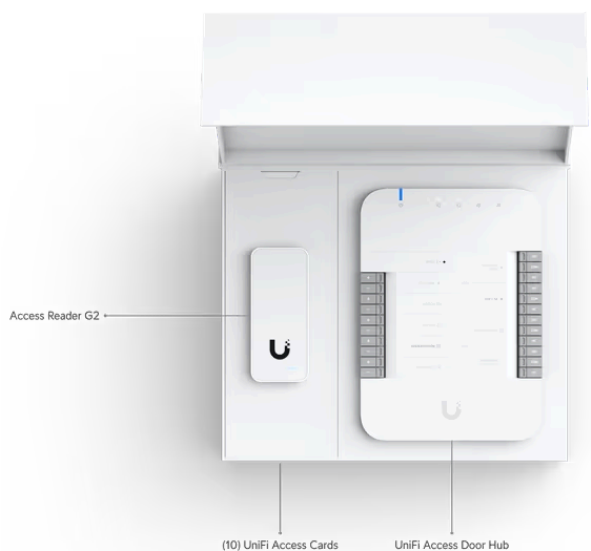

UA-Hub-Door Mechanical

Dimensions 174.9 x 126 x 32.9 mm (6.9 x 5 x 1.3")

Weight 363 g (12.8 oz)

Enclosure material Polycarbonate

Mounting material Polycarbonate

Hardware

| | |
|--|---|
| Networking interface | (5) 10/100/1000 Base-T |
| Power method | PoE++ UL 294 Power-limited Class 2 PSU UL 60950/62368 LPS/PS2 PSU |
| Max. power consumption | Without PoE output: 30W With PoE output: 50W |
| PoE input | 50V DC, 1A |
| PoE output | PoE passthrough, (4) PoE, 50V DC, total 20W |
| Button | (1) Factory-reset |
| LEDs | System: white/blue Output relays: white |
| Digital input | Request to exit/request to enter/remote release/door position sensor |
| Dry output relay | Lock: 30V DC, 1A Aux: 30V DC, 1A |
| Powered output relay | Lock: 12V DC, 1A Aux: 12V DC, 0.33A 12V DC, 0.33A |
| Operating environment | Indoor use only |
| Ambient operating temperature | 0 to 40° C (32 to 104° F) |
| Ambient operating humidity | 5 to 95% noncondensing |
| UL 294 level | Destructive attack: Level I Line security: Level I Endurance: Level I Standby power: Level I |
| UL 294 statement | Compliance with IEEE 802.3 (at or af) specifications was not verified as per UL 294. The equipment is intended to comply with the section of the National Electrical Code (NEC) 725.121, Power Sources for Class 2 and Class 3 Circuits. |
| CAN/ULC-60839-11-1 Grade | Grade assignment: 1 |
| Certifications | CE, FCC, IC, UL 294, CAN/ULC-60839-11-1 |
| Document number, and issue date and/or revision level | UA-Hub-Door002, V01 |

Wiring Information

| Wiring gauge requirements (AWG) | Total length to device | Output load current at 12V DC |
|---------------------------------|------------------------|-------------------------------|
|---------------------------------|------------------------|-------------------------------|

100mA

6.1 m (20 ft) 22

15.2 m (50 ft) 22

30.5 m (100 ft) 22

UACC-Cable-DoorLockRelay (18 AWG) is recommended.

PoE cabling requirements

The minimal conductor gauge permitted to connect between the PSE or p (0.21 mm²) for horizontal or riser cable.

LEDs**PoE in**

Steady blue: Adopted/device is ready
 Steady white: Pending adoption
 Blinking white/blue: Upgrading firmware

PoE out

Off: Not connected or no data link
 Steady blue: Connected and data link on

UA-G2**Mechanical****Dimensions**

93 x 40 x 36.5 mm (3.7 x 1.6 x 1.4")

Weight

82 g (2.9 oz)

Enclosure material

Polycarbonate, glass

Mounting

In wall, gang box

Weatherproofing

IP55

Hardware**Networking interface**

(1) 10/100 MbE RJ45 port

Connectivity

BLE 4.1

Power method

PoE
 UL 294 Power-limited Class 2 PSU
 UL 60950-1/62368-1 LPS/PS2 PSU

| | |
|--|--|
| Supported voltage range | 48V DC |
| Max. power consumption | 5W |
| ESD/EMP protection | Air: ±15kV, contact: ±8kV |
| Sensors | Proximity sensor |
| Speaker | (1) 8 ohm, 0.7W |
| LEDs | R/G/B/W |
| Button | (1) Factory-reset |
| NFC frequency | 13.56 MHz |
| NFC read range | < 30 mm |
| NFC standards | ISO 14443A, 14443B, 15693 |
| NFC technology | NFC Tag 1,2,3,4,5 MIFARE Classic MIFAREPlus MIFARE Ultralight MIFARE DESFire |
| Operating environment | Outdoor use |
| Ambient operating temperature | -30 to 45° C (-22 to 113° F) |
| Ambient operating humidity | 5 to 90% noncondensing |
| Software information | The software version of a product can be checked at https://unifi.ui.com |
| UL 294 level | Destructive attack: Level I Line security: Level I Endurance: Level I Standby power: Level I |
| UL 294 statement | Compliance with IEEE 802.3 specifications was not verified as part of UL. The equipment is intended to comply with the section of the National Electrical Code (NEC) 725.121, Power Sources for Class 2 and Class 3 Circuits. |
| PoE cabling requirements | Cable 5e cabling is the minimum performance category recommended. To match the transmission speed required at the installation site. The minimal conductor gauge permitted to connect between the PSE or powered device (PD) is 26 AWG (0.13 mm ²) for patch cords; 24 AWG (0.21 mm ²) for horizontal or riser cabling. |
| CAN/ULC-60839-11-1 Grade | Grade assignment: I |
| Certifications | CE, FCC, IC, UL 294, CAN/ULC-60839-11-1 |
| Document number, and issue date and/or revision level | UA-G2/UA-G2-Black, V02 |

LED

System

- Steady blue: Adopted/device is ready
- Steady white: Pending adoption
- Blinking white/blue: Upgrading firmware
- Strobing red: Emergency lockdown

UA-Card Mechanical

Dimensions 85.6 x 53.98 x 0.84 mm (3.37 x 2.13 x 0.03")

Weight 5 g (0.18 oz)

Format ISO 7810 ID-1

NFC frequency 13.56 MHz

NFC technology ISO/IEC 14443 Type A
MIFARE DESFire
UniFi Access Proprietary Security Protocol

Stay in Touch

[Terms and Conditions](#) | [Terms of Service](#) | [Privacy Policy](#) | [Return Policy](#) | [Cookies Settings](#)

© 2024 Ubiquiti, Inc. All rights reserved.