



## 2N® Indoor Touch

The stylish multifunctional Communicator 2N® Indoor Touch fits elegantly into any interior. One glance at the display panel will let you know who is standing outside your door, to let you start a dialogue or open the door lock. In addition, in combination with 2N IP intercoms you'll obtain a comprehensive system for door communication.



Villas  
Residential complexes  
Condominiums

Luxury residences  
Modern interiors  
Office complexes

### Luxury designed for your interior

Combine luxurious design, high-tech processing and timeless application. Choose between elegant black or pure white.

### 7" touch screen

Get to the key functions with one click. All thanks to the high resolution touch-screen and wide viewing angle.

### Audio in HD quality

Experience crystal clear sound. In addition, with echo suppression you'll feel like you're talking to your caller face-to-face.

# 2N® Indoor Touch

## FEATURES & BENEFITS

### Video monitoring of 2N IP intercoms

With 2N® Indoor Touch you can view video from the intercom camera at any time. This allows you to have a constant overview of what is happening outside the door.

### 15-minute installation

The communicator is not only easily wall-mounted, but easy to configure thanks to automatic device search over the network.

### Missed calls and video voicemail

When it comes to missed or omitted calls you always have available a preview from the 2N IP intercom camera, to better identify the caller.

### “Do Not Disturb” Mode

“Do not disturb” service activation will prevent the ring-tone from sounding during the chosen time interval. You use it when you need to some peace and calm.

### Doorbell button support

The Doorbell button by the apartment or house entrance can be easily connected direct to the 2N® Indoor Touch unit.

### Remote administration via Web interface

You will welcome the comfortable device configuration and management available via any Web browser from anywhere in the world.

### PBX Integration

Thanks to SIP protocol support the communicator is easily integrated with your current telecommunications solutions.

### Home automation management

You can easily install 3rd party Android applications for home automation systems control on your 2N® Indoor Touch.

## DIAGRAM

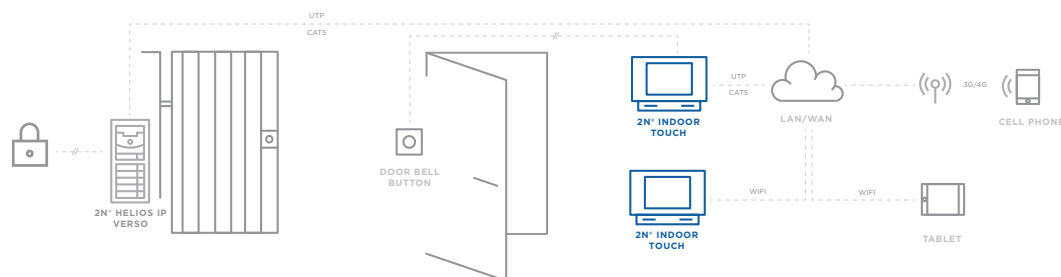

## TECHNICAL PARAMETERS

### Power supply

Type	External power adapter 12 V DC 2A / PoE 802.3af
Power consumption	10 W

### User interface

Capacitive touch panel	16:9
Display size	7"
Resolution	1024x600px 24bpp (16.7 million colours)
Backlighting	LED with standby mode
Status indicator	1x RGB LED (missed calls, standby, etc.)
Configuration	local or remote via the web

### Operating system

Android 4.2.2

### Audio

Microphone	built-in
Speaker	1x2W integrated
Protocol	SIP, G.711, G.722

### Video

Protocol	H.264, MJPEG
Supervision and control of the intercom	Yes
IP camera surveillance	Yes

### Interfaces

LAN	Ethernet 10/100BaseT, RJ-45
WiFi	802.11b/g/n, integrated antenna (optional)
2x Relay	
2x GPIO	
Memory card	microSD card (up to 16 GB)

### Mechanical parameters

Wall mounted	
Dimensions (W x H x D)	235 x 165 x 40 mm
Weight	850 g
Operating temperature	0°C – 60°C
Operating relative humidity	10% – 90% (non-condensing)
Storage temperature	from -20°C to 70

## HARDWARE & SOFTWARE

**2N® Helios IP Verso** – modular security intercom for the most discerning customers

**2N® Helios IP Force** – arguably the most robust IP intercom worldwide

**2N® Helios IP Vario** – a variable intercom with an elegant design

**2N® Helios IP Mobile** – an application that displays the image from the intercom camera on your mobile device display

**2N® Access Commander** – software to manage 2N IP intercoms and access units